

General Details

Unit	TYPE: OUTSIDE CURB DIM.: SLOPE: QUANTITY:	Ridge Unit 120.00" x 60.00" x 2 3/4" 2.4 : 12 1
Panel	CORE MATERIAL: CORE THICKNESS: U-VALUE:	Non-Conductive FRP Grid 2 11/16" 0.40
Grid	COLOR: DIMENSIONS:	Standard 6" x 9"
Exterior Skin	COLOR: FINISH:	White Smooth with Gelcoat- 10 weather surface
Interior Skin	COLOR: FINISH:	Crystal Embossed
Accessories	FRP SKIRT: ALUMINUM:	Black Skirt Painted

Note

Please verify job conditions and dimension points to be as shown. Correct if different.

Approved

By: _____

Date: _____

Customer	Project Name	Distinctive Skylights 535 A Street Richmond, CA 94801 Phone: 510-235-5125 Fax: 510-235-5085 www.DistinctiveSkylights.com	Scale 1:1
			Sheet No. 1

Single Ridge Panel

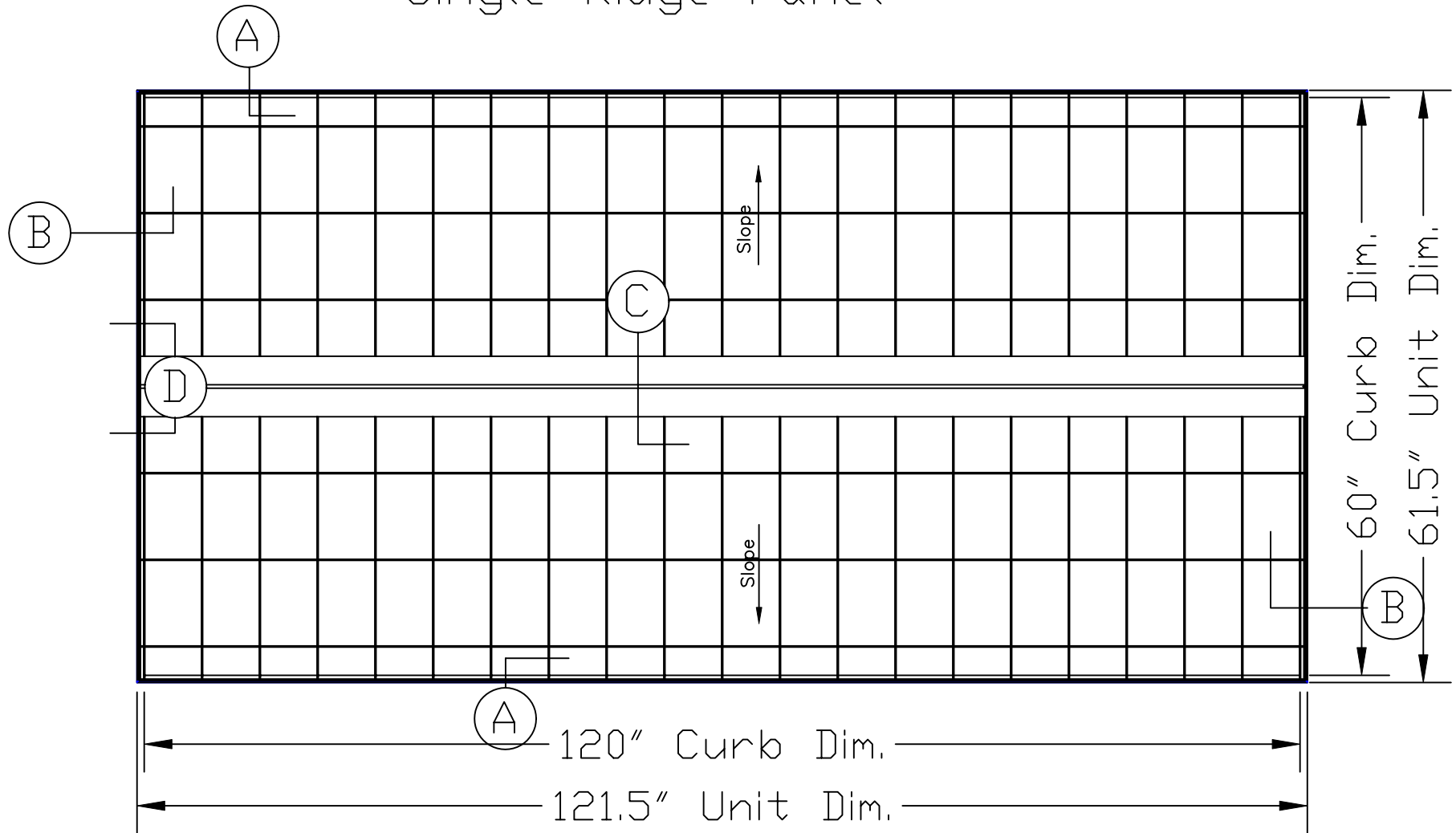

Customer	Project Name	Distinctive Skylights 535 A Street Richmond, CA 94801 Phone: 510-235-5125 Fax: 510-235-5085 www.DistinctiveSkylights.com	Scale 1:1 Sheet No. 2
----------	--------------	---	--------------------------------

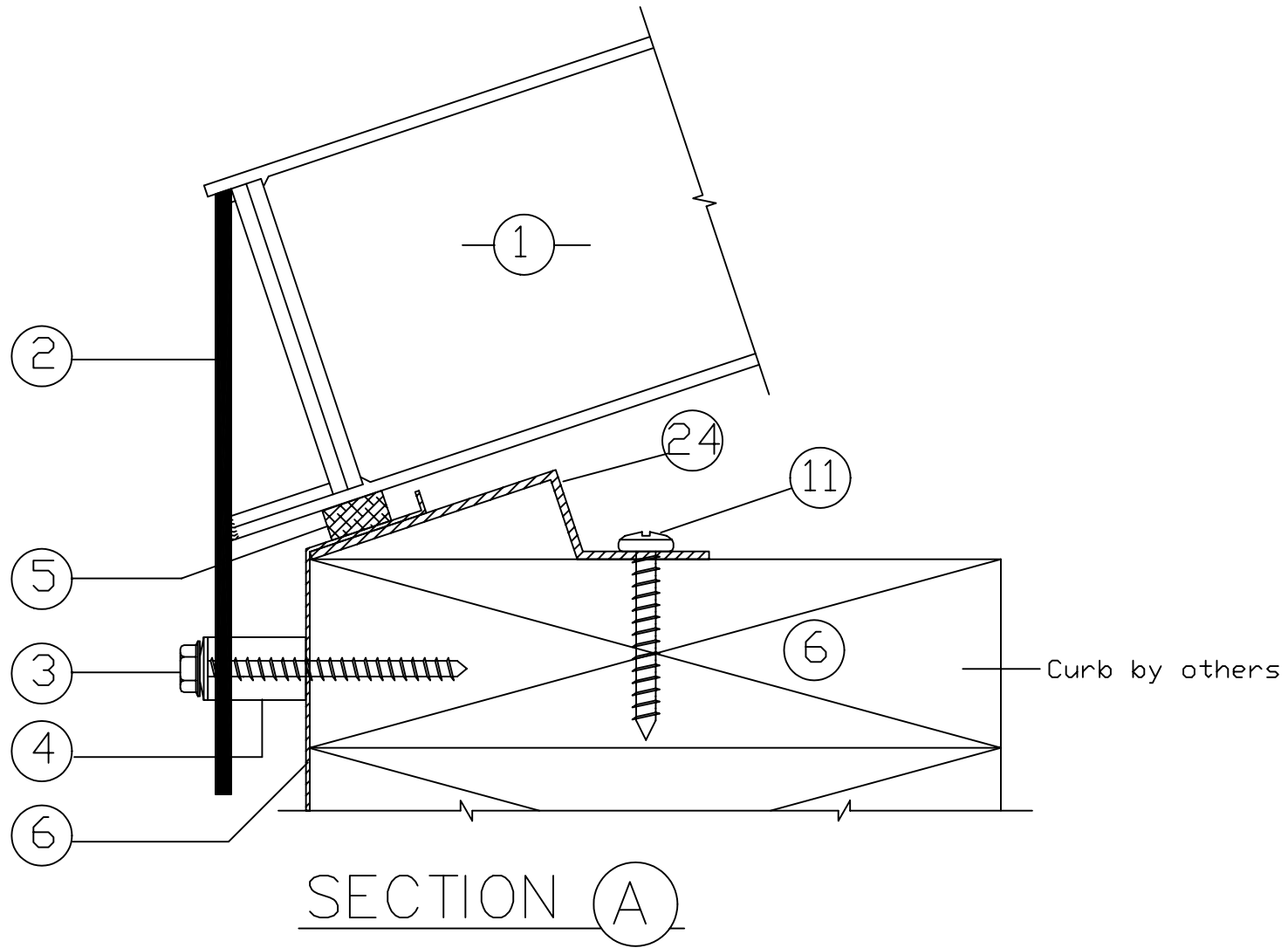

Customer

Project Name

Distinctive Skylights
 535 A Street
 Richmond, CA 94801
 Phone: 510-235-5125
 Fax: 510-235-5085
 www.DistinctiveSkylights.com

Scale
 1:1

Sheet No.

3

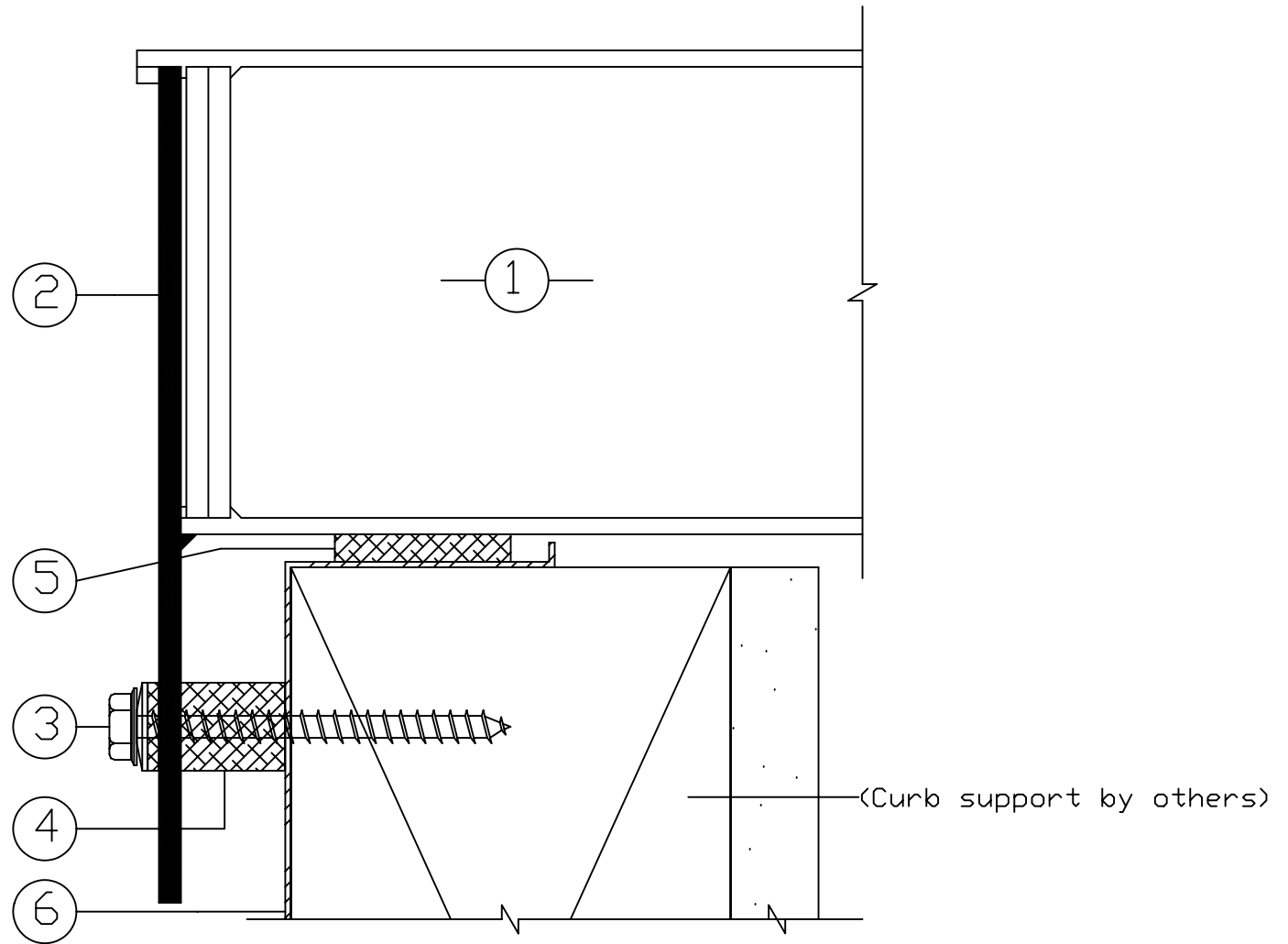

SECTION (B)

Customer	Project Name	Distinctive Skylights 535 A Street Richmond, CA 94801 Phone: 510-235-5125 Fax: 510-235-5085 www.DistinctiveSkylights.com	Scale 1:1
			Sheet No. 4

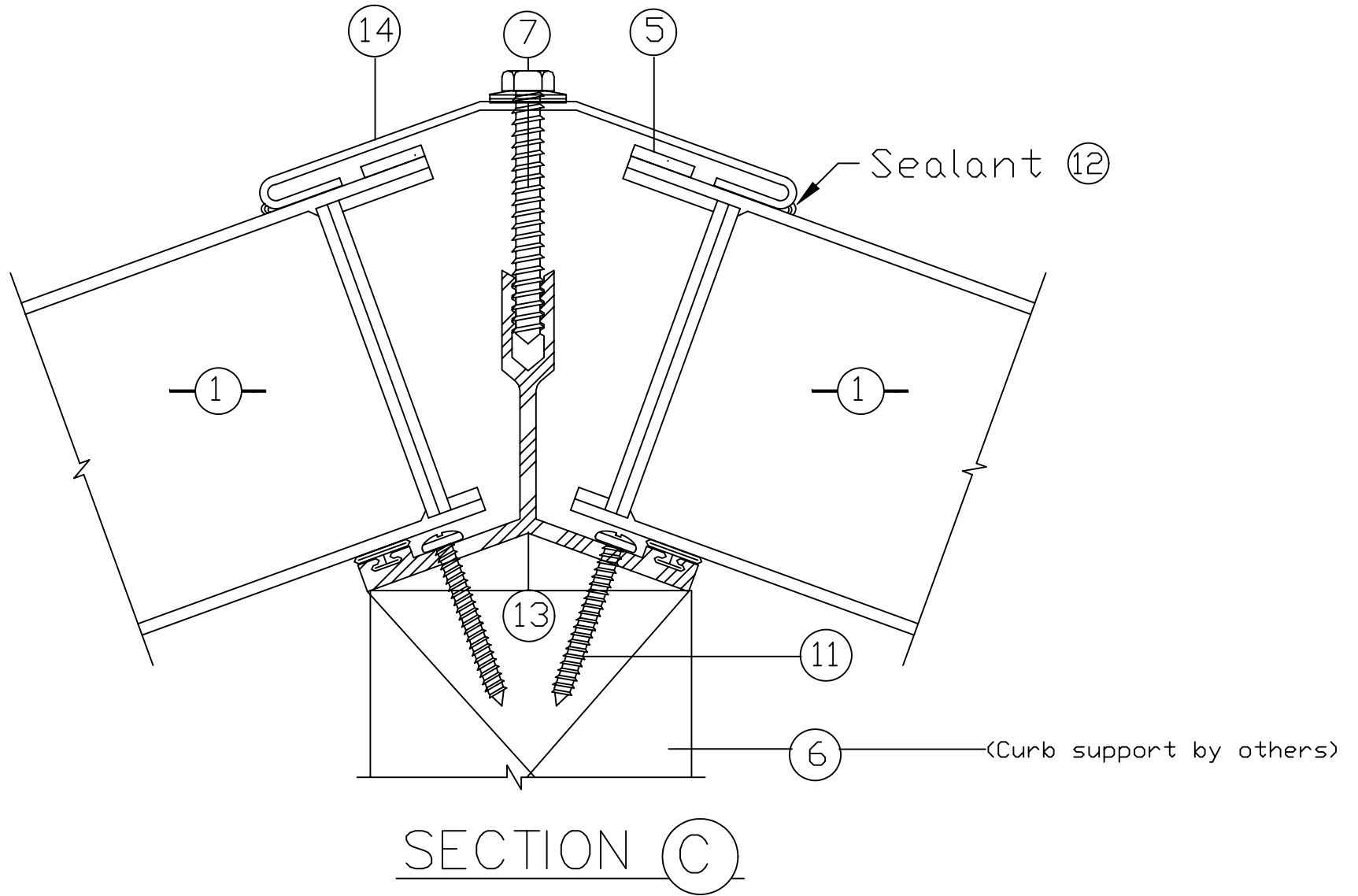

Customer

Project Name

Distinctive Skylights
 535 A Street
 Richmond, CA 94801
 Phone: 510-235-5125
 Fax: 510-235-5085
 www.DistinctiveSkylights.com

Scale
 1:1

Sheet No.

5

DETAIL CODE:

- 1 DISTINCTIVE SKYLIGHTS TRANSLUCENT PANEL
- 2 FRP FLASHING
- 3 #14 x 2" S.S. HEX HD / DBL WASHER
- 4 NEOPRENE SPACER
- 5 FOAM TAPE 1/4" x 1"
- 6 CURB / COUNTER FLASHING NOT BY DISTINCTIVE SKYLIGHTS
- 7 #14 x 2 S.S. HEX HD / DBL WASHER
- 11 #12 X 1 1/2" S.S. PAN HD SCREW
- 12 SEALANT
- 13 DS RIDGE BATTEN PER SLOPE - (6063-T5)
- 14 RIDGE CAP - FABRICATED 0.063 ALUMINUM
- 15 END CAPS - FABRICATED 0.063 ALUMINUM
- 19 #12 X 1" S.S. PAN HD SCREW
- 24 CURB ANGLE - FABRICATED 0.063 ALUMINUM

Customer	Project Name	Distinctive Skylights 535 A Street Richmond, CA 94801 Phone: 510-235-5125 Fax: 510-235-5085 www.DistinctiveSkylights.com	Scale 1:1
			Sheet No. 6